

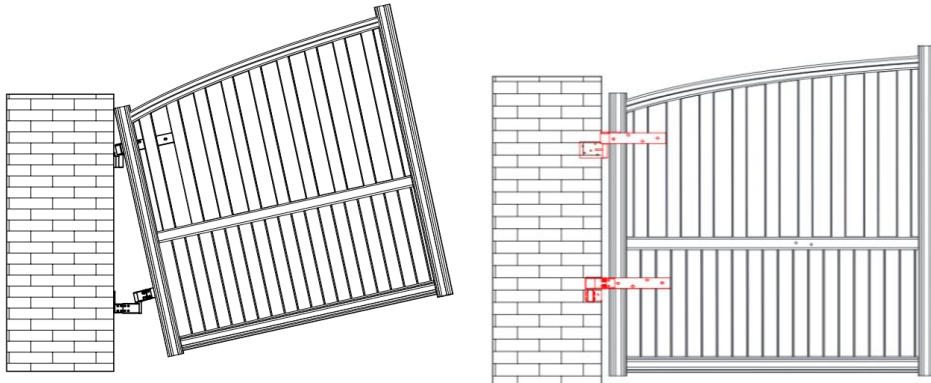

Automation Systems<sup>®</sup>  
AUSTRALIA

## Adjustable Rising Gate Installation Guideline



**Preparation:** Confirm the width of the gate and the height to be lifted then refer to the two tables below to select the appropriate hinge separation distance and to decide if the bottom leg should be used retracted or extended.

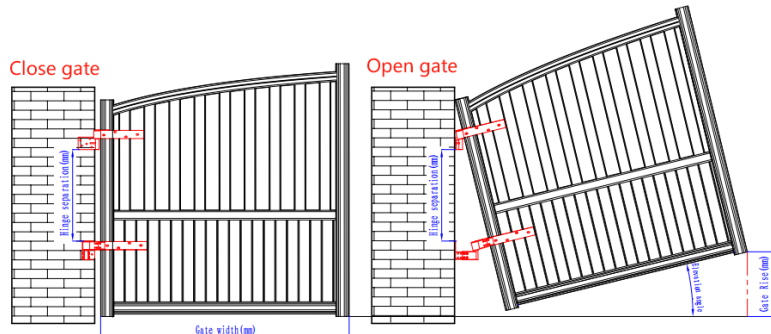

## Extended Setting for Max Rise

	Hinge separation (mm)								
	550 mm	650mm	800mm	900mm	1000mm	1100mm	1200mm	1300mm	1800mm
Elevation angle	13.6°	11.85°	9.93°	8.96°	8.17°	7.5°	6.93°	6.45°	3.69°
Gate width (mm)	Gate Rise (mm) against Hinge Separation								
900	233	206	176	161	149	138	130	122	96
1000	256	226	193	177	163	152	142	133	104
1100	280	247	211	192	177	165	154	145	112
1200	303	267	228	208	192	178	166	156	121
1300	327	288	245	223	206	191	178	167	129
1400	350	308	262	239	220	204	190	178	137
1500	374	329	280	255	234	217	202	190	146
1600	397	350	297	270	248	230	214	201	154
1700	421	370	314	286	263	243	226	212	162
1800	444	391	331	301	277	256	238	223	171
1900	468	411	349	317	291	269	250	234	179
2000	491	432	366	332	305	282	262	246	187

## Retracted Setting for Min. Rise

	Hinge separation (mm)								
	550 mm	650mm	800mm	900mm	1000mm	1100mm	1200mm	1300mm	1800mm
Elevation angle	10.56°	9.19°	7.70°	6.94°	6.32°	5.80°	5.36°	4.99°	3.69°
Gate width (mm)	Gate Rise (mm) against Hinge Separation								
900	186	165	142	130	120	112	105	99	79
1000	204	181	155	142	131	122	114	108	85
1100	223	197	168	154	142	132	124	117	92
1200	241	213	182	166	153	142	133	125	98
1300	259	229	195	178	164	152	143	134	105
1400	278	245	208	190	175	163	152	143	111
1500	296	261	222	202	186	173	161	151	117
1600	314	277	235	214	197	183	171	160	124
1700	333	293	249	226	208	193	180	169	130
1800	351	309	262	239	219	203	189	177	137
1900	369	325	275	251	230	213	199	186	143
2000	388	341	289	263	241	223	208	195	150

## Installation Example

Step 1. According to the site environment and gate width, install the bottom hinges on the wall or post.

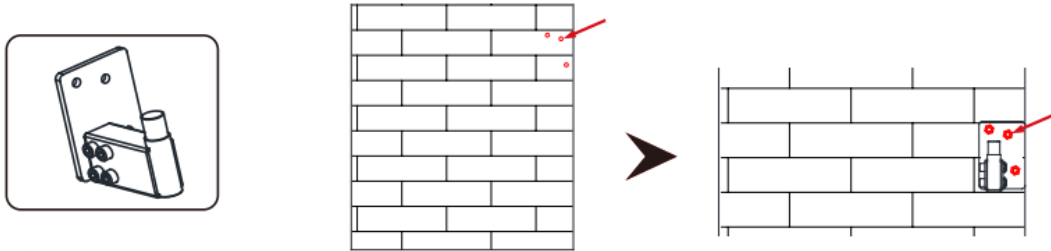

Step 2. Install the top hinge according to the height to be lifted.

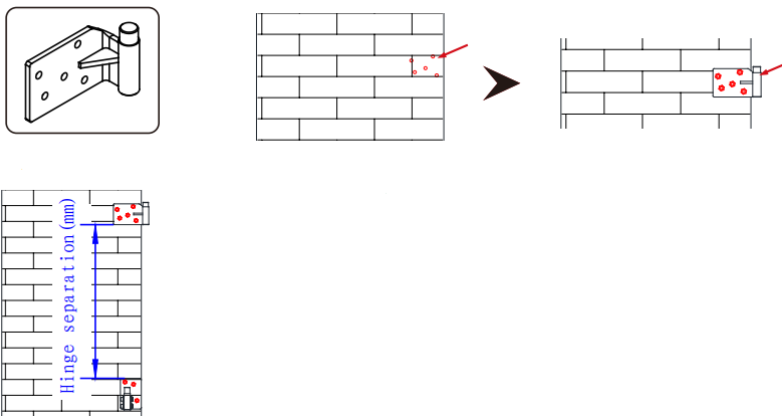

Step 3. Install the Top and bottom strap hinge to the gate ensuring that they match to the post/wall hinges previously installed.

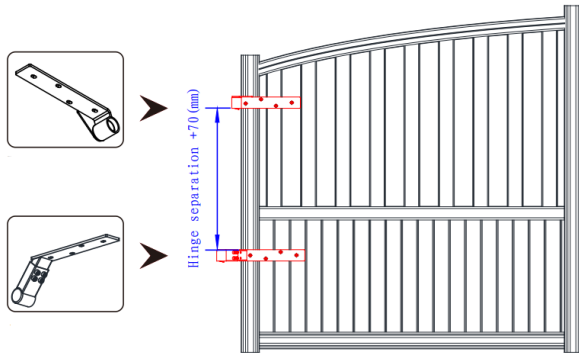

Step 4. Apply a proper amount of lubricating oil to the bearings of the top strap hinge and the bottom hinge.

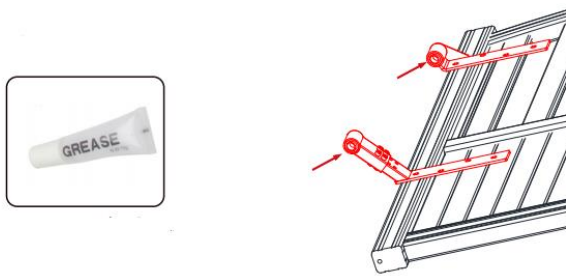

Step 5. Assemble the gate and hinges together.

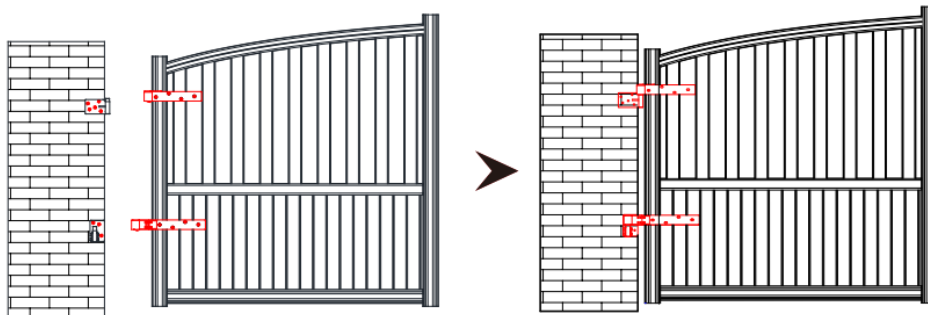

Step 6. Manually open and close the gate to check if it meets the requirements. If the gate lifting height is not ideal, adjust the hole positions of the bottom hinge and the bottom strap hinge. Install the bottom hinge reinforcement plate

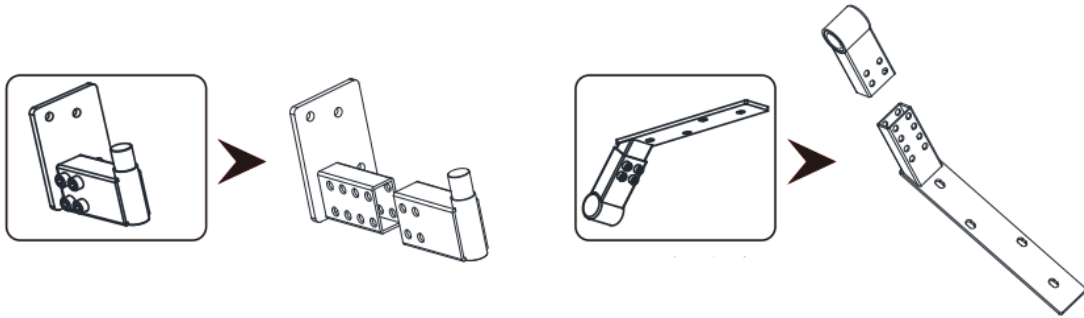

Step 7. Install the bottom strengthening plate.

